



BLACK CAT

WEAR PARTS



PC5500

ASSEMBLY

PC5500

Part Number	Description	Weight	A	B	C
RVMS130B6000	Adapter Base	413.1 lb 187.4 kg	14.25" 362 mm	14.96" 380 mm	20.16" 512 mm
RVM6000RS	Tooth	177.5 lb 80.5 kg	10.66" 271 mm	15.81" 402 mm	17.42" 443 mm
RVMS130C1700	Lip Shroud	730.2 lb 331.2 kg	9.25" 235 mm	31.02" 788 mm	17.00" 432 mm
RVSLW550L	Lower Wing Shroud LH	370.8 lb 168.2 kg	5.66" 144 mm	25.19" 640 mm	13.72" 349 mm
RVSLW550R	Lower Wing Shroud RH	371.7 lb 168.6 kg	5.66" 144 mm	25.19" 640 mm	13.72" 349 mm
RVS550V3200	Upper Wing Shroud	534.4 lb 242.4 kg	5.66" 144 mm	19.60" 498 mm	32.44" 824 mm
WCLS640	Wear Cap	262.8 lb 119.2 kg	12.50" 318 mm	18.44" 468 mm	20.36" 517 mm

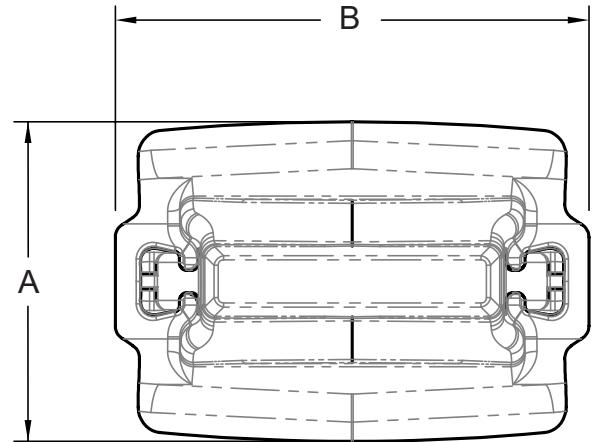

Hardware

Part Number	Description	Weight	A	B	C
RVM6000P	Tip Pin	13.1 lb 5.9 kg	2.22" 56 mm	2.72" 69 mm	10.24" 260 mm
RVM6000PLUG	Tip Pin Plug	0.4 lb 0.2 kg	1.34" 34 mm	1.81" 46 mm	4.00" 102 mm
RVS13B	Wing Shroud Base	18.3 lb 8.3 kg	2.95" 75 mm	6.40" 163 mm	8.16" 207 mm
RVS11B	S130 Lip Shroud Base	27.8 lb 12.6 kg	2.87" 73 mm	8.15" 207 mm	9.34" 237 mm
RVS11LP	Lip & Wing Shroud Lock	12.4 lb 5.6 kg	1.51" 38 mm	4.35" 111 mm	8.36" 212 mm
RVS175BL	Lip & Wing Shroud Seat	8.1 lb 3.7 kg	2.25" 54 mm	4.12" 305 mm	4.37" 111 mm
RVS175B	Lip & Wing Shroud Bolt	8.1 lb 3.7 kg	2.25" 54 mm	4.12" 305 mm	4.37" 111 mm

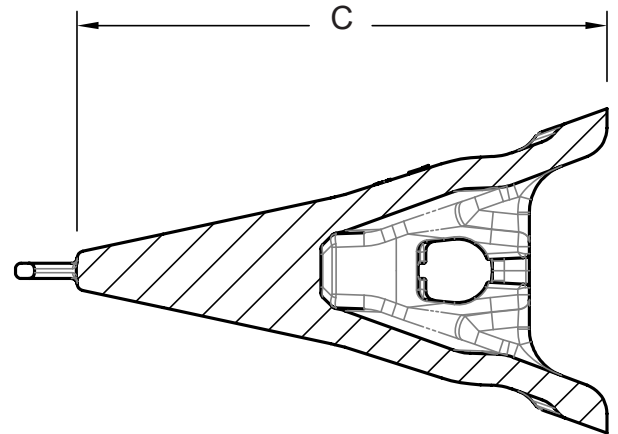

REVOLUTION

Caterpillar® and other identities and/or trademarks referred to in this publication are the registered marks of the entities noted herein. The use of any trademarks of others than Black Cat Wear Parts Ltd. are solely and exclusively for identification, informational, comparative, and descriptive purposes. Black Cat Wear Parts Ltd. is not affiliated with any owner of such registered marks and does not make, use, or sell any products manufactured by any such entity identified in this publication.

www.blackcatwearparts.com
sales@blackcatwearparts.com
 +1-780-465-6666
 1-800-661-6666

**STRONG ENOUGH
 TO ANSWER ANY CALL!**
 800.0824